

**EXPLODED VIEW**

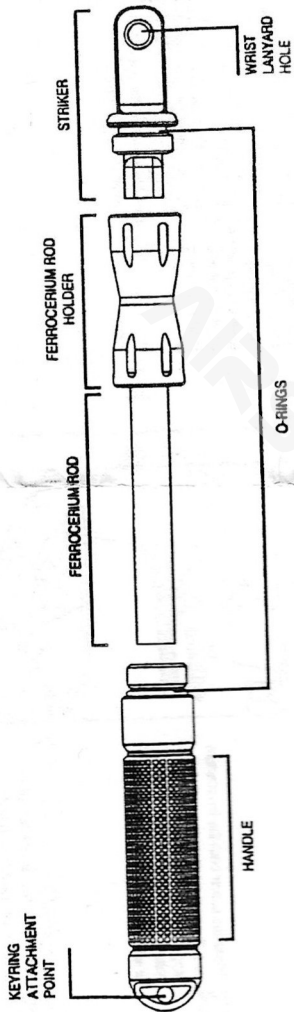

**USER GUIDE**

**LIFETIME WARRANTY**

Please contact customer service for a replacement.

**FIRE STARTER**



**CAUTION:**

THE HOT METAL SHAVINGS CAN BURN THROUGH CLOTHING AND CAUSE SEVERE BURNS.

**i**

## INSTRUCTIONS:

### USE THE STRIKER

The ferrocerium rod creates extremely hot burring metal shavings and sparks ideal for starting fires with flammable liquids, rain or shine. This is done by the frictional heat created when quickly scraping material from the rod.

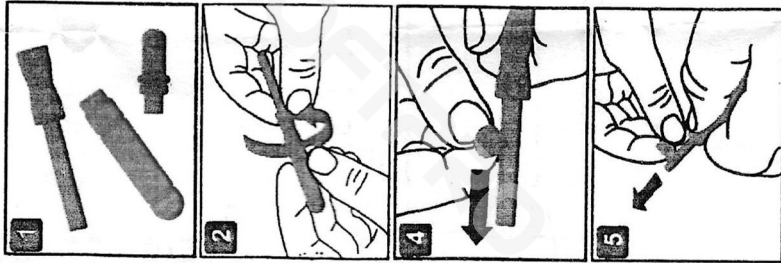

**1** Unscrew the striker and the rod holder from the handle.

**2** Flip the rod holder around and screw back onto handle.

**3** Grip the striker between index finger and thumb.

**4** Place the striker onto the ferrocerium rod. For best results, use approximately a 45 degree angle. When the striker is angled correctly it will bite into the rod.

**5** In one quick movement, scrape the striker down the rod as though trying to carve material from the ferrocerium rod.

### SHARPEN THE STRIKER

The striking tool insert is made from a very hard tungsten carbide material. This manufacturing process allows for a very durable and sharp tool that will retain its edge through thousands of uses. The striker should not be used on materials other than the ferrocerium rod to prevent chipping its edge. Sharpening of the tungsten carbide striker is not necessary if properly maintained.

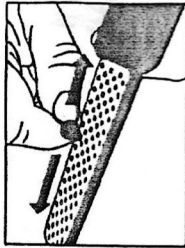

**1** Place the short side of the striker onto the sharpening tool.

**2** Holding the tool as flat as possible against the striker, drag it across just a few times.

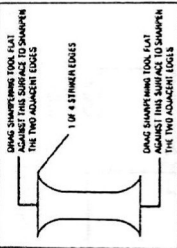

**3** Carefully inspect the striker for an improved edge. The edge should feel noticeably sharper than before but does not need to be razor sharp.

**4** The striker is sharp when it will bite into the rod with the sharp edge angled (45 degrees) to the rod.